

**NOTE:**

1. APPROXIMATE ASSEMBLED DRY WEIGHT 19.2 LB.
2. PUMP OUTPUT: 12.0 GPM MIN AT 100 PSID, 10-130 cSt. AND 1200 RPM
3. SHAFT ROTATION: BIDIRECTIONAL. SEE INLET / DISCHARGE LABELS.
4. TO SET SEAL DRAIN PLUGS FOR PROPER ROTATION:
  - A. REMOVE BOTH SAE -4 PLUGS, LABELLED AS #1, #2, AND INSTALL SEAL DRAIN PLUGS PER TABLE BELOW.

	SEAL DRAIN #1	SEAL DRAIN #2
EXTERNAL DRAIN NOT CONNECTED, CCW ROTATION	INSTALLED	<b>NOT INSTALLED</b>
EXTERNAL DRAIN NOT CONNECTED, CW ROTATION	<b>NOT INSTALLED</b>	INSTALLED
EXTERNAL DRAIN CONNECTED, CCW ROTATION	INSTALLED	INSTALLED
EXTERNAL DRAIN CONNECTED, CW ROTATION	INSTALLED	INSTALLED

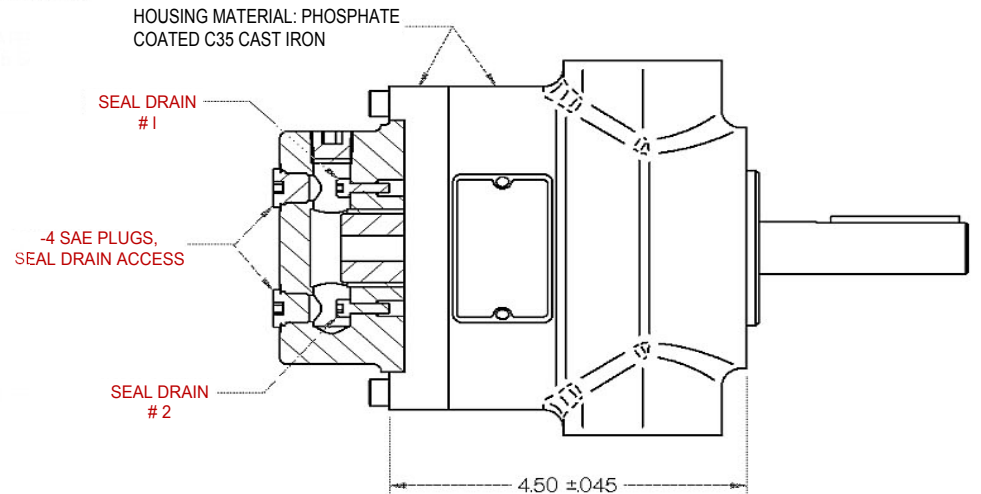
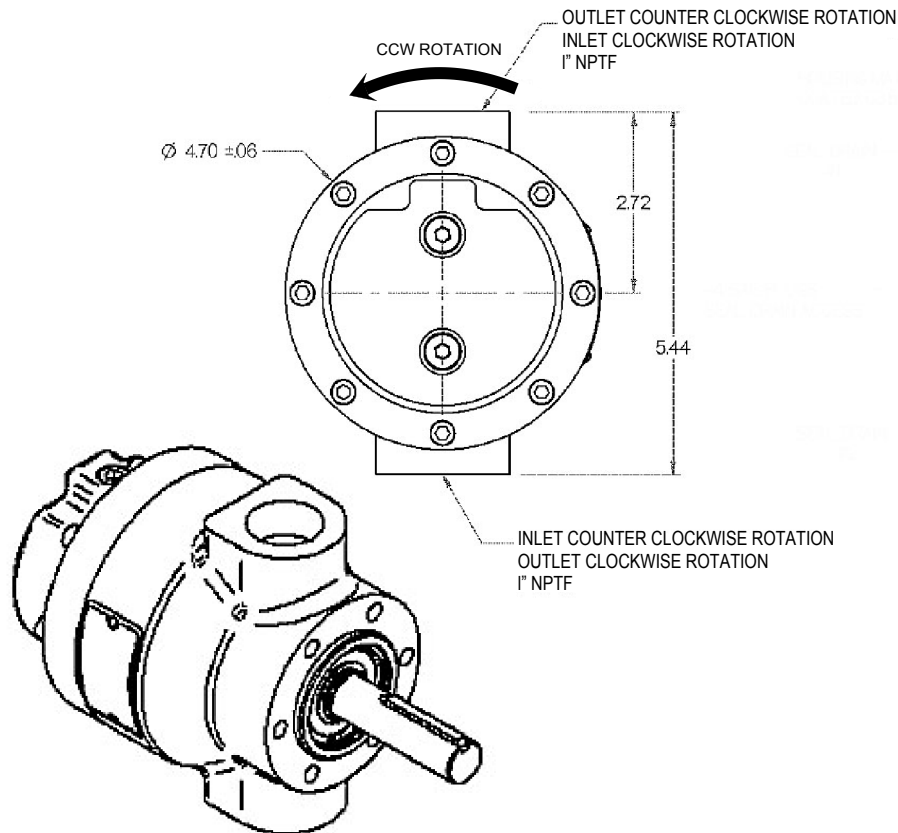
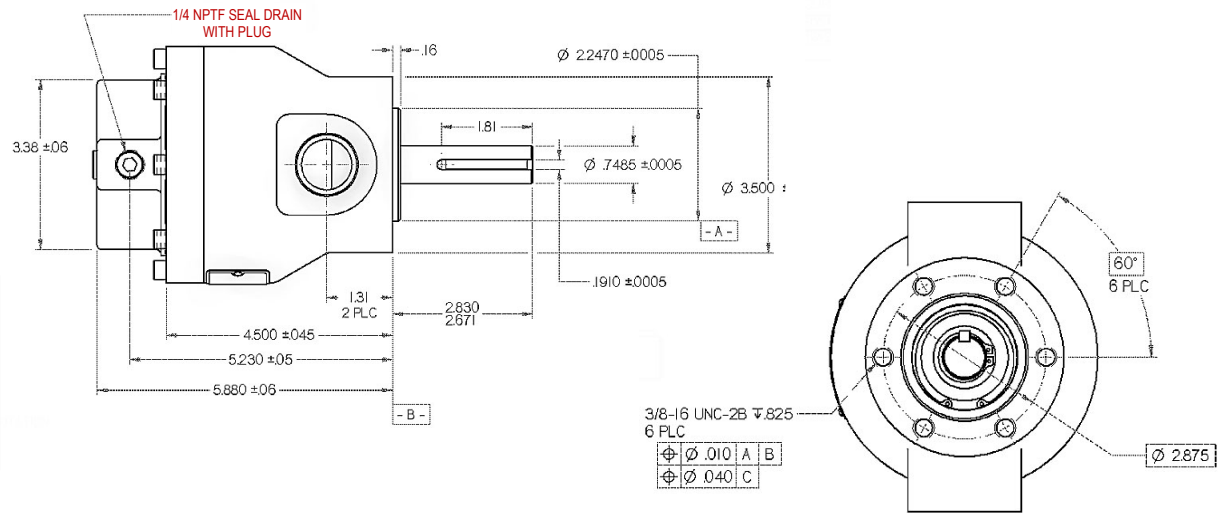

LOC	PART No.	QTY	DESCRIPTION	SCALE	DATE	
			<b>WWL INDUSTRIES, INC.</b> 2412 W. 42nd St. ODESSA, TEXAS		4/11/11	
					DRAWN	APPROVED
					CJG	
				WEIGHT	MACH. FINISH	
TITLE				DRAWING No.		
GEROTOR OIL PUMP				H12P-30-B3		